

APPLICATION FOR CERTIFICATE OF APPROPRIATENESS (COA)

Building address 99 W. Broad St.

Owner of building Arthur Schmidt Phone [REDACTED]

Owner's email & mailing address [REDACTED]

Applicant Kacper Waskiewicz / Evan Bloss - FastSigns Phone: [REDACTED]

Applicant's email & mailing address [REDACTED]

Street and Number City State Zip Code

APPLICANT MUST ATTEND MEETING FOR CASE TO BE HEARD.
USE THE CHECKLIST ON THE BACK OF THIS APPLICATION TO ENSURE YOUR SUBMISSION IS COMPLETE.

Historic & Architectural Review Board – Application form, photographs, and drawings must be submitted 2 weeks prior to the regular scheduled meeting in order to be placed on the agenda for the next meeting.

South Bethlehem & Mount Airy Historic Conservation Commission - Application form, photographs, and drawings must be submitted 2 weeks prior to the regular scheduled meeting in order to be placed on the agenda for the next meeting.

1. PHOTOGRAPHS - Photographs of your building and neighboring buildings **must accompany** your application.

2. TYPE OF WORK PROPOSED – Check all that apply. Please bring any samples or manufactures specifications for products you will use in this project.

<input type="checkbox"/> Trim and decorative woodwork	<input type="checkbox"/> Skylights
<input type="checkbox"/> Siding and Masonry	<input type="checkbox"/> Metal work
<input type="checkbox"/> Roofing, gutter and downspout	<input checked="" type="checkbox"/> Light fixtures
<input type="checkbox"/> Windows, doors, and associated hardware	<input checked="" type="checkbox"/> Signs
<input type="checkbox"/> Storm windows and storm doors	<input type="checkbox"/> Demolition
<input type="checkbox"/> Shutters and associated hardware	<input type="checkbox"/> Other _____
<input type="checkbox"/> Paint (Submit color chips – HARB only)	

3. DRAWINGS OF PROPOSED WORK – Required drawings **must accompany** your application. Please submit ONE ORIGINAL AND TEN (10) COPIES OF DRAWINGS, PHOTOGRAPHS, APPLICATION FORM, AND ANY SPECIFICATIONS

- Alteration, renovation, restoration (1/4 or 1/8"=1'0" scale drawings required IF walls or openings altered.)
- New addition (1/4" or 1/8"=1'0" scale drawings: elevations, floor plans, site plan)
- New building or structure (1/4" or 1/8"=1'0" scale drawings: elevations, floor plans, site plan)
- Demolition, removal of building features or building (1/4" or 1/8"=1'0" scale drawings: elevation of remaining site and site plan)
- A scale drawing, with an elevation view, is required for all sign submittals

4. DESCRIBE PROJECT – Describe any work checked in #2 and #3 above. Attach additional sheets as needed.

Install new window signage

5. APPLICANT'S SIGNATURE see attached DATE: 11/19/19

APPLICATION FOR CERTIFICATE OF APPROPRIATENESS (COA)

Building address 99 WEST BROAD STREET
 Owner of building ARTHUR SCHMIDT Phone [REDACTED]
 Owner's email & mailing address [REDACTED]
 Applicant Kalper Lasker Phone: 917-692-5054
 Applicant's email & mailing address 320 9th Avenue Bethlehem PA 18618
Street and Number City State Zip Code

APPLICANT MUST ATTEND MEETING FOR CASE TO BE HEARD.
USE THE CHECKLIST ON THE BACK OF THIS APPLICATION TO ENSURE YOUR SUBMISSION IS COMPLETE.

Historic & Architectural Review Board - Application form, photographs, and drawings must be submitted 2 weeks prior to the regular scheduled meeting in order to be placed on the agenda for the next meeting.

South Bethlehem & Mount Airy Historic Conservation Commission - Application form, photographs, and drawings must be submitted 2 weeks prior to the regular scheduled meeting in order to be placed on the agenda for the next meeting.

1. PHOTOGRAPHS - Photographs of your building and neighboring buildings **must accompany** your application.

2. TYPE OF WORK PROPOSED - Check all that apply. Please bring any samples or manufactures specifications for products you will use in this project.

<input type="checkbox"/> Trim and decorative woodwork	<input type="checkbox"/> Skylights
<input type="checkbox"/> Siding and Masonry	<input type="checkbox"/> Metal work
<input type="checkbox"/> Roofing, gutter and downspout	<input type="checkbox"/> Light fixtures
<input type="checkbox"/> Windows, doors, and associated hardware	<input checked="" type="checkbox"/> Signs
<input type="checkbox"/> Storm windows and storm doors	<input type="checkbox"/> Demolition
<input type="checkbox"/> Shutters and associated hardware	<input type="checkbox"/> Other _____
<input type="checkbox"/> Paint (Submit color chips - HARB only)	

3. DRAWINGS OF PROPOSED WORK - Required drawings **must accompany** your application. Please submit **ONE ORIGINAL AND TEN (10) COPIES OF DRAWINGS, PHOTOGRAPHS, APPLICATION FORM, AND ANY SPECIFICATIONS**

- Alteration, renovation, restoration (1/4 or 1/8"=1'0" scale drawings required IF walls or openings altered.)
- New addition (1/4" or 1/8"=1'0" scale drawings: elevations, floor plans, site plan)
- New building or structure (1/4" or 1/8"=1'0" scale drawings: elevations, floor plans, site plan)
- Demolition, removal of building features or building (1/4" or 1/8"=1'0" scale drawings: elevation of remaining site and site plan)
- A scale drawing, with an elevation view, is required for all sign submittals

4. DESCRIBE PROJECT - Describe any work checked in #2 and #3 above. Attach additional sheets as needed.
Vinyl/Decal store signage

5. APPLICANT'S SIGNATURE [Signature] **DATE:** 5/24/19

POLISH • EUROPEAN MARKET



KAVVA'S

★★★ ON BROAD ST ★★★
Established 2018

99 W. BRAD

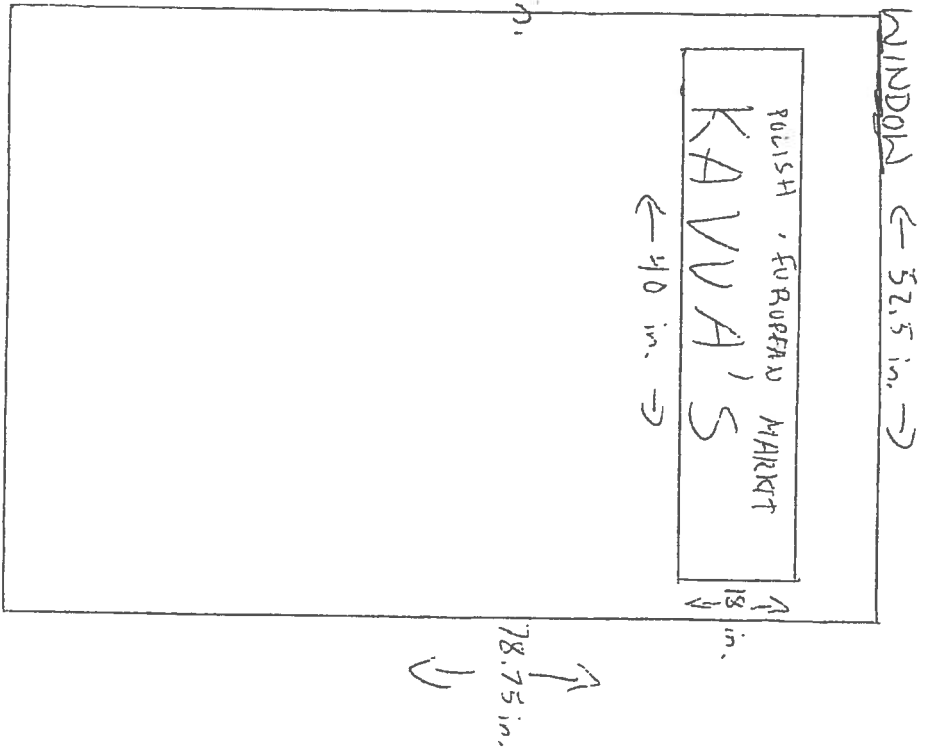
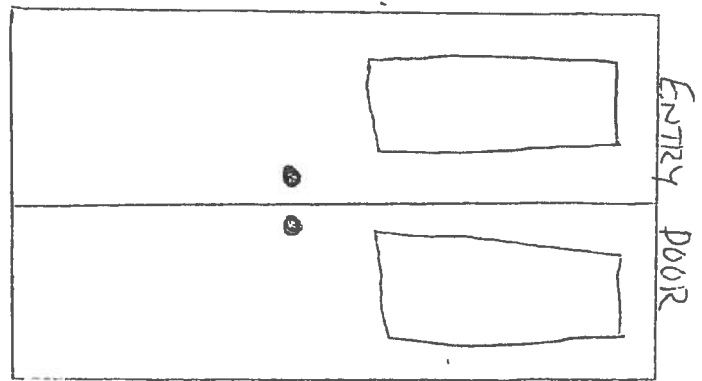
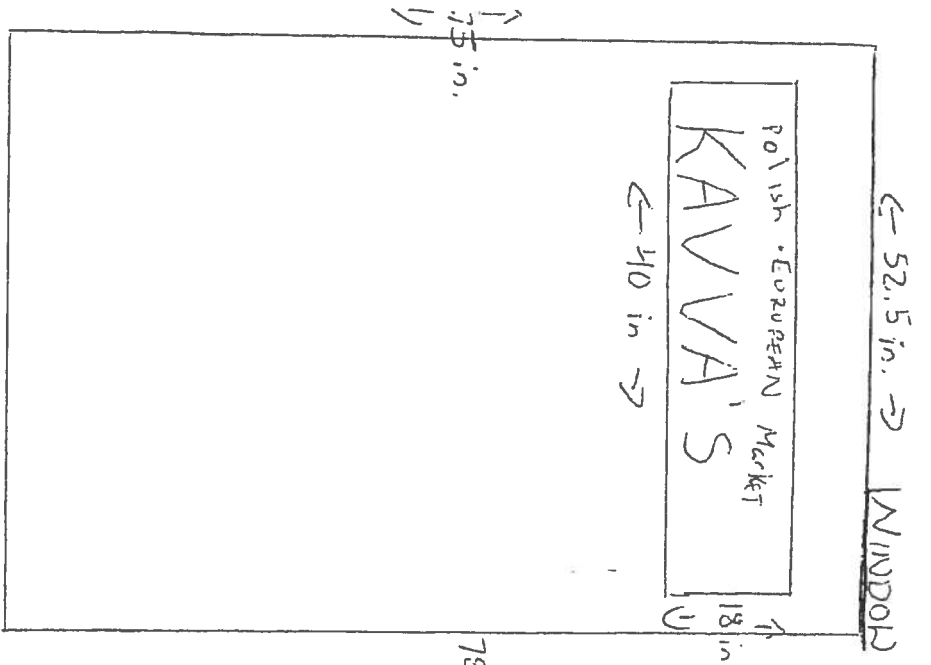

* PROOFS OF OFFICIAL LOGO ATTACHED *

COLOR SUGGESTIONS - ALL BOND WHITE OR BOND WHITE W/ MATTE GOLD OUTLINE

FASTSIGNS ALLENTOWN

700 North 13th Street, Allentown, PA 18102
Phone: 610-434-7353 / Fax: 610-434-8014

Email: 219@fastsigns.com
Web: www.fastsigns.com/219

Proposed window graphics



Approved By: _____
Customer: Kava's European Market
Material: diecut decals
Notes: x

Page: 1 of 1 Invoice #: 72231
Qty: 2 Date: Nov. 19, 2019
Height: 19.1" Salesperson: Evan
Width: 40" Designer: tn

The customer understands that this drawing is the sole property of FASTSIGNS and said customer shall not reproduce nor use in any manner except by the management of this store. Any deviation or reproduction is in violation of the law.



**PLEASE READ
CAREFULLY**



The design above is for your approval of artwork, spelling, size and placement. Please be aware that actual output colors may differ from paper prints and screen colors generated on computer monitors, phones, etc. **First and second proofs are free. Additional proofs will be billed at \$15 minimum each.**